

OFFICE FOR RENT



Space available for rent on a luxurious “A” class office building just off Omonias Avenue by the New Port traffic lights, Limassol.



Entrance lobby with manned reception to control access to office floors, serviced by two lifts.

Available space can be rented separately or joint for one tenant.

The office is ready to move in. Incorporates open plan work areas and a few private office spaces.

Including central heating, air conditioning and server room. Offices are prewired for power and light as well as CAT 6 structured cabling for communication and network. All office spaces are fitted with spacious filing cabinets.

The offices are sharing lobby at lift landing, access corridors, separate men/women W.C. and the server room in common area of 275 m² in total.



2nd FLOOR PLAN

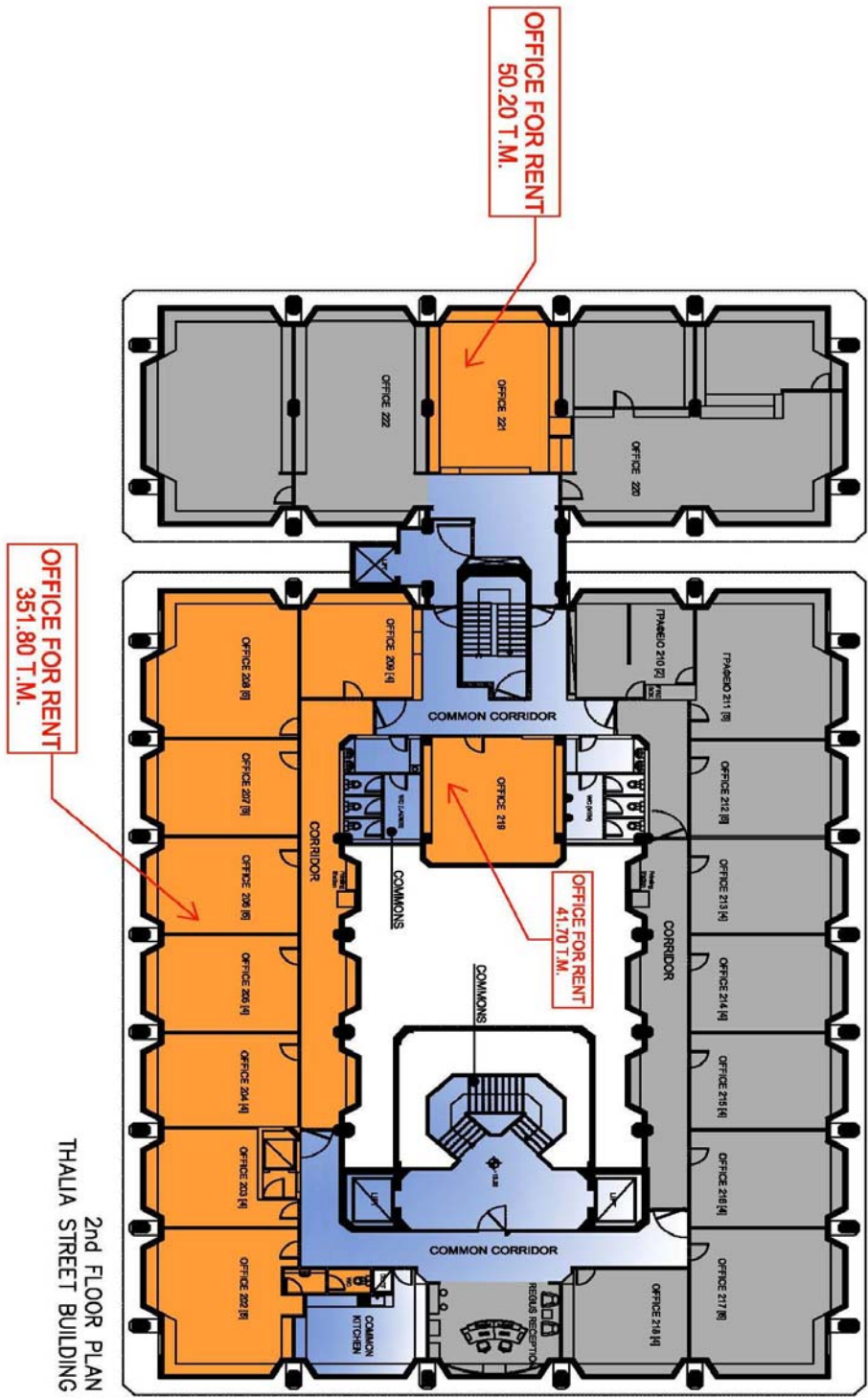

3rd FLOOR PLAN

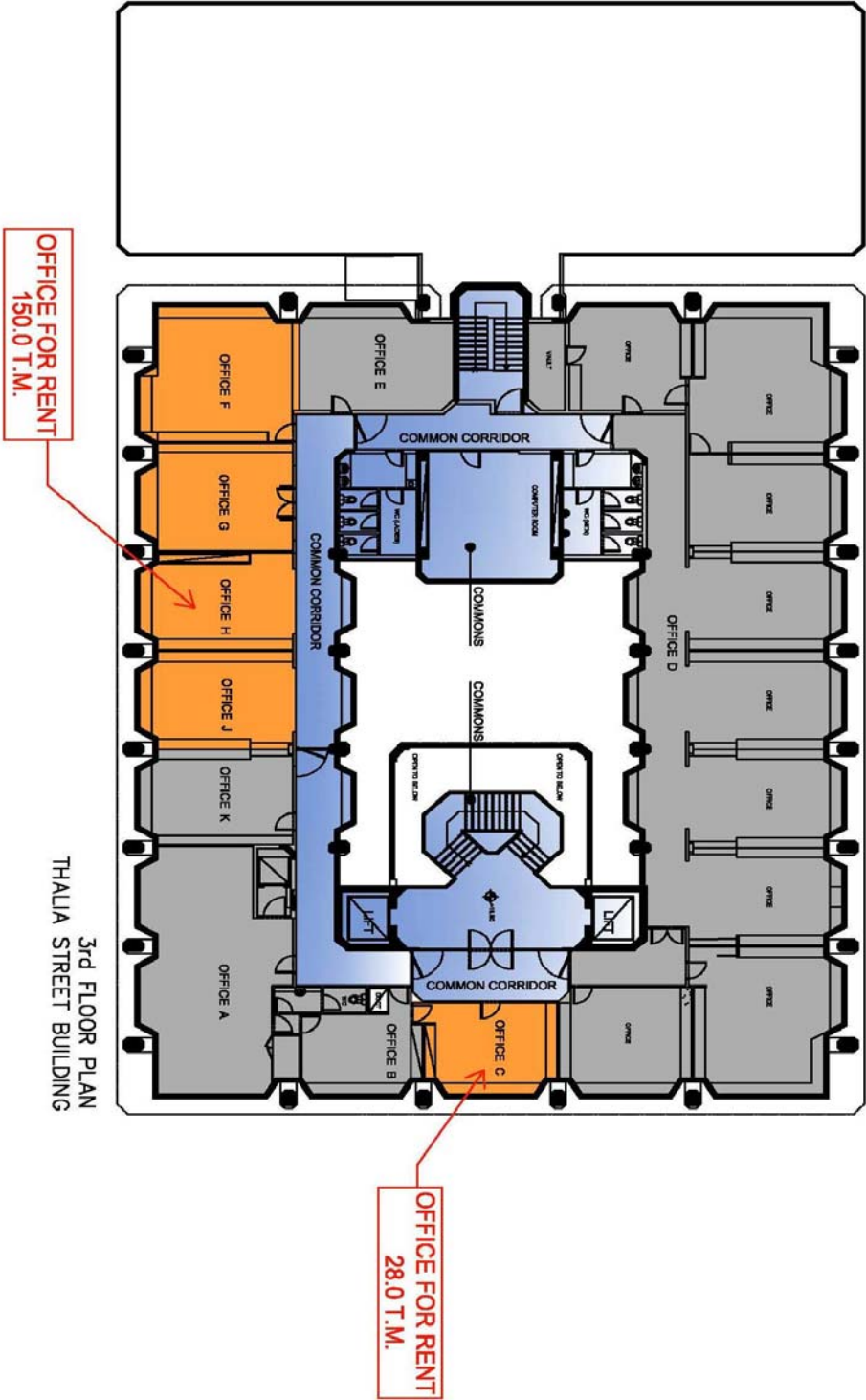

3rd FLOOR PLAN
THALIA STREET BUILDING

LOCATION MAP

Just off Omonias Avenue by the New Port Traffic Lights, on 3 Thalias Street Limassol.



Tel. +357 25 828560

Fax. +357 25 343088

Email info@pathproperty.com.cy

